

Channels: WEBCHAT/DESKTOP

By Default you are in a "Channel" for any Group or Department to which you are attached. Only one person can talk at a time.

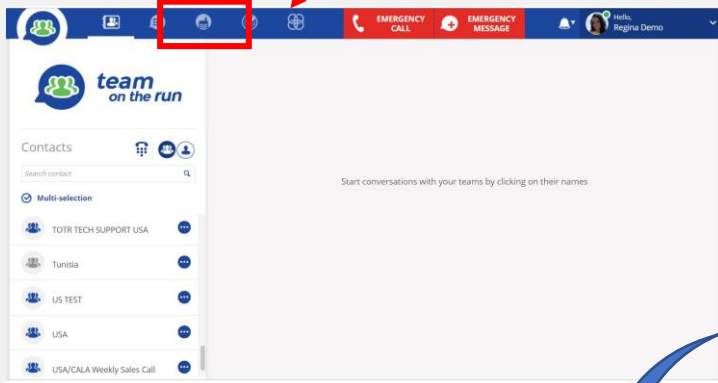

1. Select Channel Icon



2. Hard Press to see who is in Group

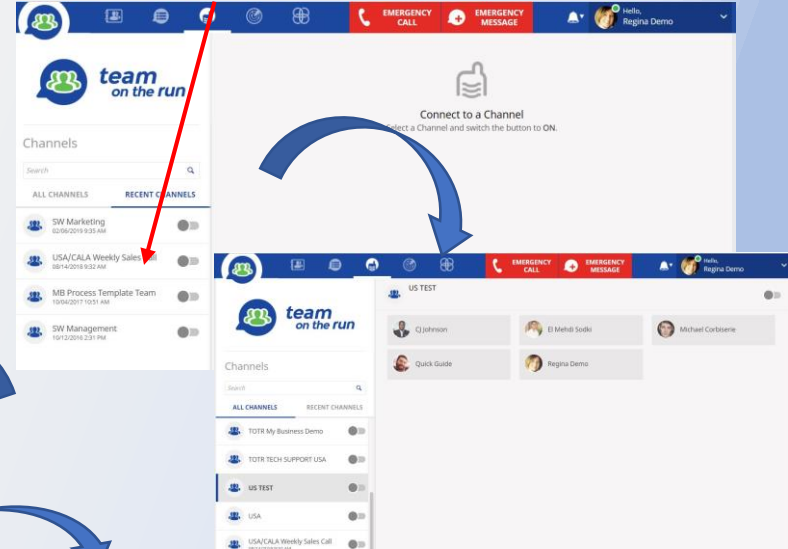

3. Click "On" To Connect to Channel

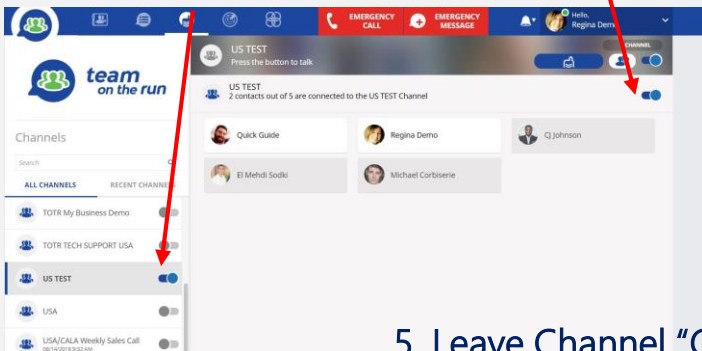

4. Push to talk/release to listen, Check who is 'On'

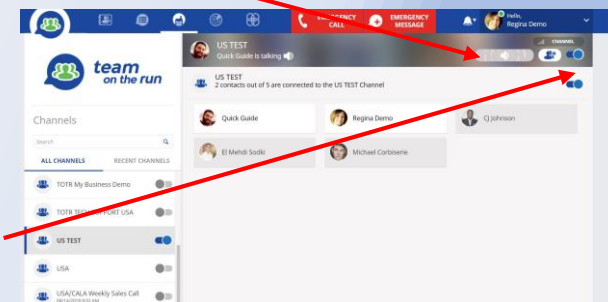

5. Leave Channel "Click off button"

For Additional Resources/User Guides visit www.mytotr.com